

DESIGN A WILDLIFE AND WELLBEING GARDEN FOR LEIGHTON PARK

A space to increase connection with nature and with ourselves.

Entrants should:

- Create a plan map, drawing or 3D model of their garden design
- Annotate or describe their design and the inspiration behind it
- Send in their entry (or photos of 3D model) by Friday 12th February 2021 to oliverstaines@leightonpark.com or by post to Garden Design Competition, care of Oliver Staines, Leighton Park School, Shinfield Road, RG2 7ED.



Requirements of your design:

In order to really impress the judges, each contesting design must have at least three of the following wildlife friendly features planned into it:

- Retain and incorporate the 6 mature trees and boundary hedge in your design
- Incorporate a wide mix of native nectar and pollen rich flowers and shrubs
- Include a mix of plants which are a breeding habitat for key insect species
- Homes for bees or insects
- Homes for wildlife (such as a hedgehog house)
- A compost heap
- Log or stone piles
- A water source
- A wildlife meadow or area of long grass.



Your garden plan should incorporate seating of some kind. This will provide a place for students or staff to connect with/observe nature; appreciate their surroundings; rest and be calm.

Your garden plan could consider:

- Plants for the senses
- Aromatic herbs and rustling textures.

Maintenance of your garden:

How will your garden cope when left alone over the summer months? It could be hot and dry with no one around to water it. In general, less pruning, mowing, digging, and replanting each year will also be better for the wildlife!

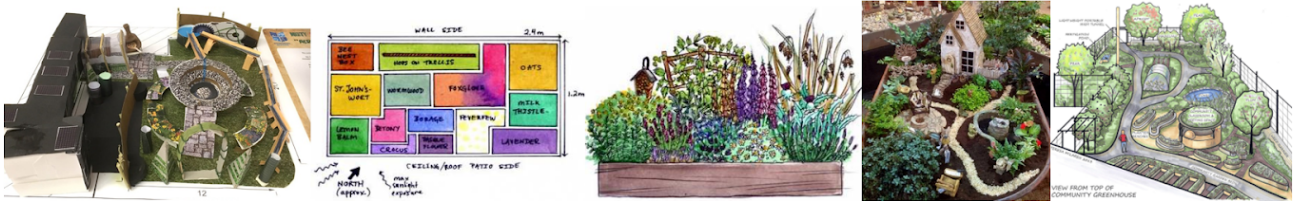

Prizes on offer:

The prizes on offer include community merits for all entries and a choice of book or garden vouchers for entries particularly commended by our judging panel.

We will also work with the winners to incorporate their ideas into a final collaborative design for the garden.

There is also, of course, the warm fuzzy glow of contributing to something which brings you together with the wider community, is bigger than yourself and will make the world a better place!

Winners will be notified no later than **Monday 8th March 2021**.



Supporting resources for inspiration and information:

[Details of the winning entries from a previous – smaller scale – similar competition run by University College London in 2016](#)

RHS school gardening information sheets to help with some of the judging criteria:

- [Creating a dry garden](#)
- [Encouraging wildlife in your school garden](#)
- [Plants for pollinators guide](#)
- [Plants for a wildlife garden](#)
- [Historic herbs](#)
- [The healing power of plants](#)

Further sources of inspiration:

- [Nigel Dunnett](#), Professor of Planting Design and Urban Horticulture, and a leading voice on innovative approaches to planting design
- Not for profit project, [Silent Space](#)
- [Nature Research Blog](#) by Professor Miles Richardson.

If you have any queries about the competition or need any further clarification of the instructions, please contact me at any point at oliverstaines@leightonpark.com



Above: Main entrance to the garden space needs to be between Townson and the Drama Studio as shown in this image from 2017.

Below: The tarmac and hardcore access track sections cannot be excavated, but features can be planned on top of these, such as seats, paths or raised beds.



